

Order  Quotation

Invoicing Details	Shipping Details
Company name: _____	Ship to: _____
Delivery date required: ___ / ___ / ___	_____
Delivery address: _____	<b>CUSTOMER STAMP AND SIGNATURE</b>
P. Code.: _____ Town: _____	
Tel.: _____ Fax: _____	
# Order: _____ Date of the Order: ___ / ___ / ___	

Pro Medicare srl grants **24 months** warranty on production defects from the date of the first put into service and **12 months** on covers and components subjected to wearing. Warranty is void if the product is used in any other way than stated in the Instruction Manual.

**Note:** Any request for variation in dimensions, materials and type compared to the standard does not have **CE** marking, therefore the professional user becomes the manufacturer and has the obligation to draw up the technical documentation of the device (this is valid for the sections of the sheet with the letter **W**; the prices of the **W** items are not present on this order form)

Images are purely illustrative and may not fully reflect reality.

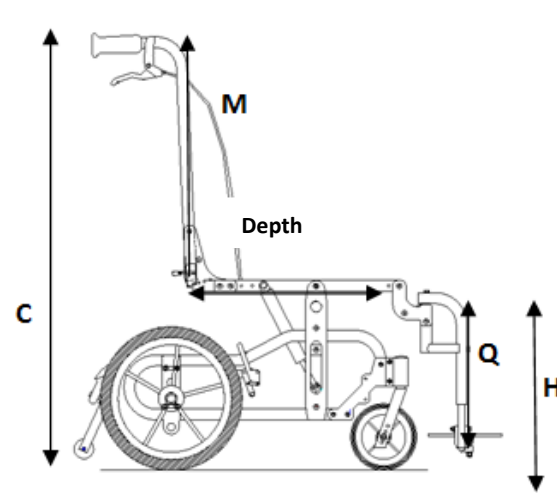
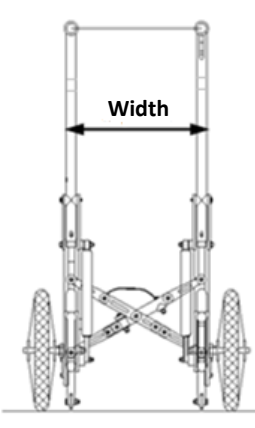
Standard Configuration																										
<ul style="list-style-type: none"> <li>- Adacta Liga satin anodised Frame</li> <li>- Fixed folding down back posts</li> <li>- Reclining mechanism by predetermined plate w/pin 3°, 9°, 15°, 22°</li> <li>- Continuous Tilt in space by drive lever: paediatric from 2° up to 35° (from 6° up to 39°)<sup>1</sup> adult from 4° up to 30° (from 8° up to 34°)<sup>1</sup></li> </ul> <p><sup>1</sup> tilt in space can be up-graded of 4° with increment of the starting inclination of the frame by operating on the positioning holes of the casters forks</p> <ul style="list-style-type: none"> <li>- Fixed anti-tip system</li> <li>- Wheels Kit with brake</li> <li>- Adjustment of the seat depth</li> <li>- Height adjustment: high (49 cm from the floor)/low (43 cm from the floor)*</li> </ul> <p>*(with 300mm and 500mm wheels only)</p> <ul style="list-style-type: none"> <li>- Knee angle</li> <li>- Foot Plates</li> <li>- Simple Calf Strap</li> </ul>																										
<b>Frame Type</b>	<input type="checkbox"/> Rigid <input type="checkbox"/> Folding																									
<b>Frame Color</b>	<input type="radio"/> Blue <input type="radio"/> Red <input type="radio"/> Turquoise <input type="radio"/> Pink <input type="radio"/> Titanium																									
<b>Frame Size</b>																										
(Width measurements are from tube to tube externally, while depth measurements are from back post to footboard engagement).																										
	<table border="1"> <thead> <tr> <th></th> <th>Seat Width (cm)</th> <th>Depth and Adjustment (cm)</th> </tr> </thead> <tbody> <tr> <td rowspan="4"><b>Paediatric</b></td> <td><input type="radio"/> US</td> <td>30    <input type="radio"/> 36 <b>◇ 38.5</b> <input type="radio"/> 41 <input type="radio"/> 44</td> </tr> <tr> <td><input type="radio"/> XXS</td> <td>35    <input type="radio"/> 36 <b>◇ 38.5</b> <input type="radio"/> 41 <input type="radio"/> 44</td> </tr> <tr> <td><input type="radio"/> XS</td> <td>35    <input type="radio"/> 40 <b>◇ 42.5</b> <input type="radio"/> 45 <input type="radio"/> 48</td> </tr> <tr> <td><input type="radio"/> XS0</td> <td>38    <input type="radio"/> 40 <b>◇ 42.5</b> <input type="radio"/> 45 <input type="radio"/> 48</td> </tr> <tr> <td rowspan="6"><b>Adult</b></td> <td><input type="radio"/> XS1</td> <td>38    <input type="radio"/> 44 <b>◇ 46.5</b> <input type="radio"/> 49 <input type="radio"/> 52</td> </tr> <tr> <td><input type="radio"/> S</td> <td>41    <input type="radio"/> 44 <b>◇ 46.5</b> <input type="radio"/> 49 <input type="radio"/> 52</td> </tr> <tr> <td><input type="radio"/> M</td> <td>41    <input type="radio"/> 48 <b>◇ 50.5</b> <input type="radio"/> 53 <input type="radio"/> 56</td> </tr> <tr> <td><input type="radio"/> M1</td> <td>44    <input type="radio"/> 48 <b>◇ 50.5</b> <input type="radio"/> 53 <input type="radio"/> 56</td> </tr> <tr> <td><input type="radio"/> L</td> <td>47    <input type="radio"/> 44 <b>◇ 46.5</b> <input type="radio"/> 49 <input type="radio"/> 52</td> </tr> <tr> <td><input type="radio"/> XL</td> <td>47    <input type="radio"/> 48 <b>◇ 50.5</b> <input type="radio"/> 53 <input type="radio"/> 56</td> </tr> </tbody> </table>		Seat Width (cm)	Depth and Adjustment (cm)	<b>Paediatric</b>	<input type="radio"/> US	30 <input type="radio"/> 36 <b>◇ 38.5</b> <input type="radio"/> 41 <input type="radio"/> 44	<input type="radio"/> XXS	35 <input type="radio"/> 36 <b>◇ 38.5</b> <input type="radio"/> 41 <input type="radio"/> 44	<input type="radio"/> XS	35 <input type="radio"/> 40 <b>◇ 42.5</b> <input type="radio"/> 45 <input type="radio"/> 48	<input type="radio"/> XS0	38 <input type="radio"/> 40 <b>◇ 42.5</b> <input type="radio"/> 45 <input type="radio"/> 48	<b>Adult</b>	<input type="radio"/> XS1	38 <input type="radio"/> 44 <b>◇ 46.5</b> <input type="radio"/> 49 <input type="radio"/> 52	<input type="radio"/> S	41 <input type="radio"/> 44 <b>◇ 46.5</b> <input type="radio"/> 49 <input type="radio"/> 52	<input type="radio"/> M	41 <input type="radio"/> 48 <b>◇ 50.5</b> <input type="radio"/> 53 <input type="radio"/> 56	<input type="radio"/> M1	44 <input type="radio"/> 48 <b>◇ 50.5</b> <input type="radio"/> 53 <input type="radio"/> 56	<input type="radio"/> L	47 <input type="radio"/> 44 <b>◇ 46.5</b> <input type="radio"/> 49 <input type="radio"/> 52	<input type="radio"/> XL	47 <input type="radio"/> 48 <b>◇ 50.5</b> <input type="radio"/> 53 <input type="radio"/> 56
	Seat Width (cm)	Depth and Adjustment (cm)																								
<b>Paediatric</b>	<input type="radio"/> US	30 <input type="radio"/> 36 <b>◇ 38.5</b> <input type="radio"/> 41 <input type="radio"/> 44																								
	<input type="radio"/> XXS	35 <input type="radio"/> 36 <b>◇ 38.5</b> <input type="radio"/> 41 <input type="radio"/> 44																								
	<input type="radio"/> XS	35 <input type="radio"/> 40 <b>◇ 42.5</b> <input type="radio"/> 45 <input type="radio"/> 48																								
	<input type="radio"/> XS0	38 <input type="radio"/> 40 <b>◇ 42.5</b> <input type="radio"/> 45 <input type="radio"/> 48																								
<b>Adult</b>	<input type="radio"/> XS1	38 <input type="radio"/> 44 <b>◇ 46.5</b> <input type="radio"/> 49 <input type="radio"/> 52																								
	<input type="radio"/> S	41 <input type="radio"/> 44 <b>◇ 46.5</b> <input type="radio"/> 49 <input type="radio"/> 52																								
	<input type="radio"/> M	41 <input type="radio"/> 48 <b>◇ 50.5</b> <input type="radio"/> 53 <input type="radio"/> 56																								
	<input type="radio"/> M1	44 <input type="radio"/> 48 <b>◇ 50.5</b> <input type="radio"/> 53 <input type="radio"/> 56																								
	<input type="radio"/> L	47 <input type="radio"/> 44 <b>◇ 46.5</b> <input type="radio"/> 49 <input type="radio"/> 52																								
	<input type="radio"/> XL	47 <input type="radio"/> 48 <b>◇ 50.5</b> <input type="radio"/> 53 <input type="radio"/> 56																								
 																										
<p><b>H:</b> seat rails to floor height (see page 6)  <b>Q:</b> length from seat rails to footplate (see page 6)  <b>C:</b> push handles height to floor = 110 cm  <b>M:</b> push handles height from seat rails (see page 2)</p> <p><b>Notes:</b> If a selection is not made, the product will be delivered in its standard configuration. (See <b>bold</b> items)</p> <p><b>◇ = Standard</b>    <input type="radio"/> = Optional without up-charge  <input type="checkbox"/> = Optional with up-charge</p>																										

## FRAME OPTIONS



### Castors

150mm (6") poly grey       black      |      175mm (7") poly       grey       black

### Posterior Wheels

- 300mm (12") poly grey with parking brake lever
- 300mm (12") poly black with parking brake lever
- 300mm (12") pneumatic grey with parking brake lever
- 300mm (12") poly black with drum brake
- 300mm (12") poly grey with drum brake
- 300mm (12") pneumatic grey with drum brake
- 300mm (12") poly black with drum brake and parking brake lever
- 300mm (12") poly grey with drum brake and parking brake lever
- 300mm (12") pneumatic grey with drum brake and parking brake lever
- 400mm (16") poly black with parking brake lever (only 45 cm height)
- 400mm (16") poly black with drum brake (only 45 cm height)
- 400mm (16") poly black with drum brake and parking brake lever (only 45 cm height)
- 500mm (20") poly grey without handrims with parking brake lever       handrims for 500mm (20") wheels
- 500mm (20") pneumatic grey without handrims with parking brake lever
- 500mm (20") pneumatic grey with handrims with drum brake
- 500mm (20") pneumatic grey with handrims with drum brake and parking brake lever
- 600mm (24") pneumatic grey with handrims with parking brake lever (not available on size US)  
(NOTE. The tilt in space is reduced to 20°, only 47 cm height)

### Knee Angle

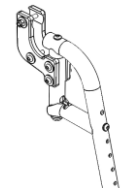
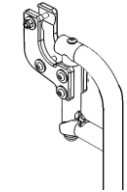
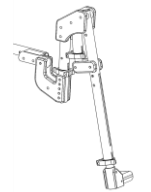
<b>Paediatric Sizes</b> from US-XS0 (detachable)	 <b>Angle 90°</b> <input checked="" type="checkbox"/> RH <input checked="" type="checkbox"/> LH	 <b>Angle 75°</b> <input type="checkbox"/> RH <input type="checkbox"/> LH	 <b>Elevating</b> (with teathed mechanism) from 80° up to 180° with a gap of 14° <input type="checkbox"/> RH <input type="checkbox"/> LH
<b>Adult Sizes</b> from XS1-XL (swing-away and detachable)	 <b>Angle 75°</b> <input checked="" type="checkbox"/> RH <input checked="" type="checkbox"/> LH	 <b>Angle 90°</b> <input type="checkbox"/> RH <input type="checkbox"/> LH	 <b>Vertical elevating and telescopic</b> <input type="checkbox"/> RH <input type="checkbox"/> LH

### Footrest

- footplates       footboard       slotted (footplates only for intra-extra rotation of 15°)
- padding and cover in leatherette       divided       one piece

### Back Posts

- Kit for fixed push handles
- Kit for push handles adjustable in height by pin (max adjustment 10 cm with 2.5 cm gap)  
**Note: height M push handles equal to 63 cm**
- Kit for telescopic push handles with lever block (max adjustment 10 cm)
- Kit for angle adjustable single handlebar for rigid frame
- Kit for angle adjustable separated handlebar for folding frame (only for paediatric frame sizes)
- Kit for telescopic and angle adjustable single handlebar
- Quick-release pins for easier backrest inclination (not valid for crash test)

### Tilt in space

- with lever       with pedal

### Anti-tip system



- fixed       detachable

## FRAME ACCESSORIES

**Seat Base** Note: The wooden seat bases present posterior notches of 6 cm for an easy movement on the seat rails

- wooden seat base covered in black leatherette (with male and female hook and loop fastening straps)
- wooden seat base with mounting kit (assembly of the various threaded inserts and clamps must be performed by the customer)
- fixed grey wooden seat base with slots

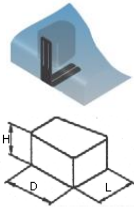
**Abductor wedge** only with rigid seat base

	<b>Size (cm)</b>	<input type="checkbox"/> S	<input type="checkbox"/> M	<input type="checkbox"/> L	<input type="checkbox"/> W	<input type="checkbox"/> removable with lever		<input type="checkbox"/> removable mounting block	
	<b>H</b>	7.5	9	10		Note: if not indicate the abductor wedge will be removable with lever  Please indicate the position of holes under the seat (if not indicated the abductor wedge will be fixed in the standard position)			
	<b>D</b>	9	10	11.5					
	<b>L</b>	7.5	9	10		<input type="checkbox"/> standard not centred			
						<input type="checkbox"/> on the RH <input type="checkbox"/> on the LH			

**Vehicle Transportation Kit** (according to the ISO 7176-19 standard)

Do not use the wheelchair as a seat in a vehicle if the weight of the user is lower than 22 kg

- only frame height 43 cm and with 300mm (12") and 500mm (20") posterior wheels (it is strongly recommended the use of a headrest)

**Wooden Supporting Base for Breathing Equipment covered in black leatherette** (available with tilt in space with lever only)

Note: Bulky equipments may lead to a reduction of the tilt in space /reclining values

- with maximum breathing equipment dimensions of: Width: 25cm; Length: 30cm; Height: 10cm
- with maximum breathing equipment dimensions exceeding 25x30x10cm

In this situation, please indicate: Width \_\_\_\_\_; Length \_\_\_\_\_; Height \_\_\_\_\_; NOTE \_\_\_\_\_

Note: Pro Medicare Srl reserves the right to check wheelchair compatibility

**Pedal for barriers**

Side  RH  LH

**Leg Support**

**Separate Leg Cradle** (adjustable in height and depth)  RH  LH  custom W

	cm	US	XXS	XS	XS0	XS1	S	M	M1	L	XL	W <sub>RH</sub>	W <sub>LH</sub>
	<b>H</b>	10	12,5	12,5	15	15	15	18	18	18	18	.....	.....
	<b>L</b>	9.5	12.5	12.5	12.5	12.5	12.5	14	14	15.5	17.5	17.5	.....

**Calf Panel** (adjustable in height and depth)  custom W

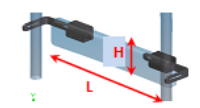
	cm	US	XXS	XS	XS0	XS1	S	M	M1	L	XL	W
	<b>H</b>	10	12	12	15	15	18	18	18	18	18	.....
	<b>L</b>	23	26,5	26,5	25	25	28	28	31	34	34	.....

**Padded Calf Strap**  custom W

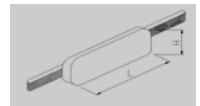
	cm	US	XXS	XS	XS0	XS1	S	M	M1	L	XL	W
	<b>H</b>	11	11	11	11	11	13	13	13	13	13	.....
	<b>L</b>	26	31	31	34	34	37	37	40	43	43	.....

**Padded Divided Leg Cradles** (adjustable in height and depth)  RH  LH  custom W

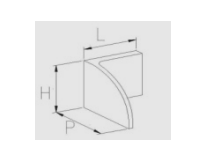
	cm	US	XXS	XS	XS0	XS1	S	M	M1	L	XL	W <sub>RH</sub>	W <sub>LH</sub>
	<b>H</b>	12.5	15	15	17.5	17.5	17.5	20	20	20	20	.....	.....
	<b>L</b>	12.5	14	14	15.5	15.5	17	17	19	22.5	22.5	.....	.....
	<b>P</b>	13.5	14	14	15	15	15	15.5	15.5	16	16	.....	.....

**Padded foot box** (adjustable in height and depth)  custom W

	cm	US	XXS	XS	XS0	XS1	S	M	M1	L	XL	W
	<b>H</b>	12.5	15	15	17.5	17.5	17.5	20	20	22.5	22.5	.....
	<b>L</b>	23.5	29	29	32.5	32.5	35.5	35.5	38.5	41.5	41.5	.....
	<b>P</b>	13.5	14	14	15	15	15	15	15.5	16	16	.....

**Cover for Knee Angle joint**  RH  LH

**Cover for legrest tube**  RH  LH

## Armrest

**Height adjustable flip back tubular armrests/inclination max 5°**

- small (L = 25 cm)
- large (L = 30 cm)

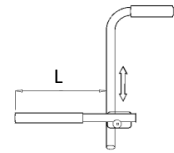

**Kit of ABS laterals multi-adjustable, detachable and w/multi-adjustable arm support in width and depth with 2.5 cm gap**

make a selection:

- small arm support (from US to XS0) (dimensions: 5 cm x 25 cm)
- large arm support (from XS1 to XL) (dimensions: 6 cm x 30 cm)

make a selection:

- short vertical bar (from 22 cm to 31 cm\*)
- long vertical bar (from 29 cm to 38 cm\*)
- \* distance from armrest to the seat rail

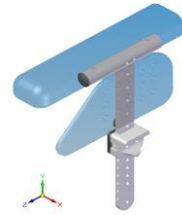

**Kit of hardware multi-adjustable, detachable for ABS laterals**

make a selection:

- short vertical bar (from 19 cm to 28 cm\*)
- long vertical bar (from 26 cm to 35 cm\*)
- \*distance from hardware to the seat rail

make a selection:

- hip guide pad ① see below
- arm support pad ② see below

ABS Lateral:  RH  LH



**Padding for ABS Laterals**  RH  LH

**Spacer for ABS laterals**  1 cm  1.5 cm  2 cm  RH  LH

## Hip Guides

**Linear Hip Guide ① (pad only)**

**Linear Hip Guide pad w/mounting bracket**

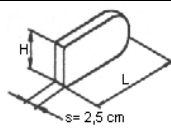

cm	XS	S	M	L	W <sub>RH</sub>	W <sub>LH</sub>
H	8	10	10	12	.....	.....
L	22	25	30	35	.....	.....

**Contoured Hip Guide ① (pad only)**

**Contoured Hip Guide pad w/mounting bracket**

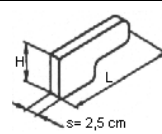

cm	XS	S	M	L	W <sub>RH</sub>	W <sub>LH</sub>
H	8	10	10	12	.....	.....
L	22	25	30	35	.....	.....

Side	Pad size	Select the bracket*	Select the bracket shape*	Side	Pad size	Select the bracket*	Select the bracket shape*
<input type="checkbox"/> RH		<input type="checkbox"/> Fixed <input type="checkbox"/> Detachable	<input type="checkbox"/> A <input type="checkbox"/> B <input type="checkbox"/> C <input type="checkbox"/> D	<input type="checkbox"/> RH		<input type="checkbox"/> Fixed <input type="checkbox"/> Detachable	<input type="checkbox"/> A <input type="checkbox"/> B <input type="checkbox"/> C <input type="checkbox"/> D
<input type="checkbox"/> LH		<input type="checkbox"/> Fixed <input type="checkbox"/> Detachable	<input type="checkbox"/> A <input type="checkbox"/> B <input type="checkbox"/> C <input type="checkbox"/> D	<input type="checkbox"/> LH		<input type="checkbox"/> Fixed <input type="checkbox"/> Detachable	<input type="checkbox"/> A <input type="checkbox"/> B <input type="checkbox"/> C <input type="checkbox"/> D

Bracket Padding:  RH  LH

Bracket Padding:  RH  LH

**Note:** If the bracket feature is not selected the fixed bracket will be delivered; for the choice of bracket shape see below

\***Brackets** (They allow adjustments of the seat and/or backrest width)

### Shape

- A** L/90° Bracket allows a reduction of the width up to 2.5 cm per side
- B** 2.5 cm Offset Bracket allows a reduction of the width up to 5 cm per side
- C** 5 cm Offset Brackets allows a reduction of the width up to 7.5 cm per side
- D** Reverse Bracket doesn't allow any variation of the width



A

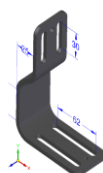

B

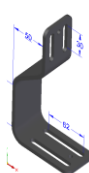

C

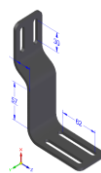

D



### Type



Fixed Bracket

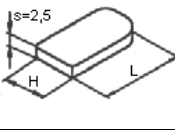

Detachable Bracket

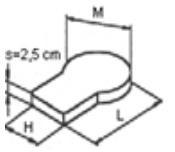
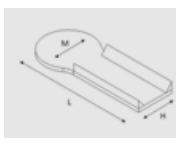
Arm Supports																	
<input type="checkbox"/> Flat Arm Support ② (pad only)							<input type="checkbox"/> Inside/outside flat Contoured Arm Support ② (pad only)										
<input type="checkbox"/> Flat arm support w/brackets							<input type="checkbox"/> Inside/outside flat Contoured arm support w/brackets										
		cm	XS	S	M	L	W <sub>RH</sub>	W <sub>LH</sub>			cm	XS	S	M	L	W <sub>RH</sub>	W <sub>LH</sub>
		H	8	10	10	12	.....	.....			H	8	10	10	12	.....	.....
		L	22	25	30	35	.....	.....			L	22	25	30	35	.....	.....
Side		Size						Side		Size							
<input type="checkbox"/> RH								<input type="checkbox"/> RH									
<input type="checkbox"/> LH								<input type="checkbox"/> LH									
<input type="checkbox"/> Flat and Shaped Arm Support ② (pad only)							<input type="checkbox"/> Inside/outside Contoured and Shaped Arm Supports ② (pad only)										
<input type="checkbox"/> Flat and Shaped Arm Support w/brackets							<input type="checkbox"/> Inside/outside Contoured and Shaped Arm Supports w/brackets										
		cm	XS	S	M	L	W <sub>RH</sub>	W <sub>LH</sub>			cm	XS	S	M	L	W <sub>RH</sub>	W <sub>LH</sub>
		H	8	10	10	12	.....	.....			H	8	10	10	12	.....	.....
		L	30	35	40	48	.....	.....			L	30	35	40	48	.....	.....
		M	12	15	17	17	.....	.....			M	12	15	17	17	.....	.....
Side		Type of Shape			Size				Side		Type of Shape			Size			
<input type="checkbox"/> RH		<input type="radio"/> palmar <input type="radio"/> elbow							<input type="checkbox"/> RH		<input type="radio"/> palmar <input type="radio"/> elbow						
<input type="checkbox"/> LH		<input type="radio"/> palmar <input type="radio"/> elbow							<input type="checkbox"/> LH		<input type="radio"/> palmar <input type="radio"/> elbow						

Wooden Tray															
<input type="checkbox"/> Ergonomic							with Hardware								
							<input type="checkbox"/> w/lateral flip <input type="checkbox"/> detachable								
<input type="checkbox"/> Rectangular							with Hardware								
							<input type="checkbox"/> w/lateral flip <input type="checkbox"/> detachable								
Padding		<input type="checkbox"/> in black leatherette		<input type="checkbox"/> in blue leatherette								Type of hardware			
<input type="checkbox"/> Outer Edge												 lateral flip		 detachable	
ergonomic tray dimensions							rectangular tray dimensions								
		Size cm	<input type="checkbox"/> US	<input type="checkbox"/> P	<input type="checkbox"/> M	<input type="checkbox"/> G			Size cm	<input type="checkbox"/> US	<input type="checkbox"/> P	<input type="checkbox"/> M	<input type="checkbox"/> G		
		P	47	53	58	66			P	45	50	55	63		
		L	58	69	75	86			L	56	66	71	82		
		B	35	42	49	55			B	35	42	48	55		
		A	17	19	21	24			A	17	19	21	24		

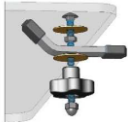
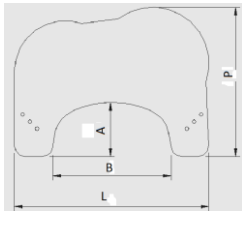
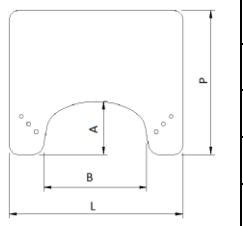
Pelvic Belt (w/2 adjustments Versa-Fixatis) (for other models please see Fixatis Range order form)						
		cm	<input type="checkbox"/> XS	<input type="checkbox"/> S	<input type="checkbox"/> M	<input type="checkbox"/> L
		H (pad height)	4.5	5.5	7	7
		L (pad length)	12	17	22	27
<input type="checkbox"/> Basket						
<input type="checkbox"/> Rain cover						
Foot Muff		<input type="checkbox"/> Blue <input type="checkbox"/> Pink <input type="checkbox"/> Grey <input type="checkbox"/> Bordeaux				
Canopy adaptor included		<input type="checkbox"/> Blue <input type="checkbox"/> Pink <input type="checkbox"/> Grey <input type="checkbox"/> Bordeaux <b>Note:</b> not available for size M1-L-XL				

FRAME DIMENSIONS AND FEATURES											
Load (kg)/ Frame Weight* (kg)	US	XXS	XS	XS0	XS1	S	M	M1	L	XL	
<b>Rigid Frame</b>	50/14.1	50/14.4	50/14.7	50/15.4	75/19.2	75/19.5	100/19.8	100/19.9	100/20.1	100/20.3	
<b>Folding Frame</b>	50/14.9	50/15.3	50/15.6	50/15.9	75/19.5	75/19.9	75/20.2	75/20.3	75/20.5	75/20.8	
* Weight of the frame, including knee angle and footplates as per standard configuration											
Overall dimensions (cm) of the frame with backrest tubes (fixed) folded down, footrest and posterior wheels detached											
Size	US	XXS	XS	XS0	XS1	S	M	M1	L	XL	
<b>Length</b>	66	66	68	68	71	73	83	83	73	83	
<b>Width</b>	<b>C</b>	30	30	30	30	30	32	32	32	32	
	<b>R</b>	42	48	48	51	51	54	54	57	60	
<b>Height</b>	65	65	66	66	67	67	68	68	67	68	
<b>Weight (kg)</b>	<b>R</b>	11.4	11.7	12	12.7	12.9	13.1	13.5	13.6	13.8	
	<b>C</b>	12.2	12.6	12.9	13.2	13.3	13.6	13.9	14	14.5	
<b>Note:</b> The length dimensions, referred to the average values, are subjected to the variations due to the displacement of the wheel plates. The values reported are intended for the standard configuration.											
Width (cm)											
<b>300mm wheel</b>	<b>standard</b>	48	53	53	56	56	59	59	62	65	
	<b>w/drum brake</b>	49	54	54	57	57	60	60	63	66	
<b>400/500mm wheel</b>	<b>standard</b>	50	55	55	58	58	61	61	64	67	
	<b>w/drum brake</b>	53	58	58	61	61	64	64	67	70	
<b>600mm wheel</b>	/	/	55	55	58	58	61	61	64	67	
<b>Pivot Width (cm)</b>		69	69	72	75	75	75	78	78	75	
<b>Q* (min-max) Height Seat rail to footplate (cm)</b>		13-23	13-23	13-26	13-26	28-36	28-36	32-40	32-40	28-36	
<b>H** Seat rail to floor (cm)</b>		43-49 with 300/500mm wheels and 150/175mm castors 45 with 400mm wheels and 150/175mm castors 47 with 600mm wheels and 150mm castors									
<b>Max Slope</b>		7°									
<b>Note:</b> *The value Q, referred to 90° footrest hanger, can be increased of about 5-7 cm by using the 75° hanger **The value H has been detected outside the seat tube at the plate of the tilt mechanism; the frame will be delivered with H=43 cm											
Length (cm)											
<b>300mm wheel</b>	<b>Without Knee angle</b>	L	70	70	73	73	75	75	78	78	
	<b>75° Knee Angle</b>	L <sub>min</sub> /L <sub>max</sub>	92/99	92/99	93/100	93/100	97/104	97/104	100/107	100/107	
	<b>90° Knee Angle</b>	L <sub>min</sub> /L <sub>max</sub>	88/96	88/96	91/99	91/99	93/100	93/100	96/103	96/103	
<b>400mm wheel</b>	<b>Without Knee angle</b>	L	74	74	77	77	79	79	82	82	
	<b>75° Knee Angle</b>	L <sub>min</sub> /L <sub>max</sub>	95/101	95/101	96/103	96/103	100/107	100/107	103/110	103/110	
	<b>90° Knee Angle</b>	L <sub>min</sub> /L <sub>max</sub>	93/99	93/99	94/100	94/100	96/102	96/102	99/104	99/104	
<b>500mm wheel</b>	<b>Without Knee angle</b>	L	78	78	81	81	84	84	87	87	
	<b>75° Knee Angle</b>	L <sub>min</sub> /L <sub>max</sub>	98/103	98/103	99/107	99/107	103/113	103/113	106/116	106/116	
	<b>90° Knee Angle</b>	L <sub>min</sub> /L <sub>max</sub>	95/101	95/101	97/102	97/102	100/106	100/106	103/109	103/109	
<b>600mm wheel</b>	<b>Without Knee angle</b>	L	/	83	84	84	85	85	88	88	
	<b>75° Knee Angle</b>	L <sub>min</sub> /L <sub>max</sub>	/	101/109	103/112	103/112	108/116	108/116	111/120	111/120	
	<b>90° Knee Angle</b>	L <sub>min</sub> /L <sub>max</sub>	/	98/104	101/107	101/107	105/112	105/112	108/116	108/116	
L = Length of the frame without knee angle joint mechanism; L <sub>min</sub> = Length of the frame with knee angle joint mechanism and footplate positioned backward; L <sub>max</sub> = Length of the frame with knee angle joint mechanism and footplate positioned forward <b>Note:</b> The length dimensions, referred to the average values, are subjected to variations due to the displacement of the wheel plates. The values reported are intended for the standard configuration.											

