



| | | |
|--|---|--|
| Anti-tip system | <input checked="" type="checkbox"/> fixed | |
| | <input type="checkbox"/> detachable | |
| Tilt in space | <input checked="" type="checkbox"/> with lever | <input type="checkbox"/> with pedal |
| Pelvis Positioning System | | |
| <input checked="" type="checkbox"/> Inserto Seat Basico | <input type="checkbox"/> Inserto Seat Mediano | <input type="checkbox"/> Inserto Seat Domino |
| <input type="checkbox"/> Waterproof seat cover with elastic band | | |
| Trunk Positioning System | | |
| <input checked="" type="checkbox"/> Inserto Back Effecto Lato | <input type="checkbox"/> Inserto Back Supporto | |
| Lumbar pushing insert <input checked="" type="checkbox"/> RH <input checked="" type="checkbox"/> LH | Lumbar containment insert <input type="checkbox"/> RH <input type="checkbox"/> LH | |
| Backpost (Note: Push handles height 63 cm) | | |
| <input checked="" type="checkbox"/> Kit for fixed push handles | | |
| <input type="checkbox"/> Kit for push handles adjustable in height by pin (max adjustment 10 cm with 2.5 cm gap) | | |
| <input type="checkbox"/> Kit for telescopic push handles with lever block (max adjustment 10 cm) | | |
| <input type="checkbox"/> Kit for angle adjustable single handlebar for rigid frame | | |
| <input type="checkbox"/> Kit for telescopic and angle adjustable single handlebar | | |
| <input type="checkbox"/> Kit for angle adjustable handlebar for folding frame | | |
| <input type="checkbox"/> Quick-release pins for easier backrest inclination (not valid for crash test) | | |

Accessories



Thoracic Supports for Inserto Back Supporto *Please, indicate the type, the shapes and the size desired

| | | |
|---|--|---|
| Type of Bracket | Shape of the Pad | |
| Fixed <input type="checkbox"/> RH <input type="checkbox"/> LH | Flat <input type="checkbox"/> RH <input type="checkbox"/> LH |  |
| Swing-Away <input type="checkbox"/> RH <input type="checkbox"/> LH | Contoured <input type="checkbox"/> RH <input type="checkbox"/> LH |  |

| | | | | |
|----|---------------------------------|---------------------------------|---------------------------------|---------------------------------|
| cm | <input type="checkbox"/> size 1 | <input type="checkbox"/> size 2 | <input type="checkbox"/> size 3 | <input type="checkbox"/> size 4 |
| H | 6 | 8 | 10 | 12 |
| L | 6,5 | 8,5 | 10,5 | 13,5 |



| | | | |
|----|---------------------------------|---------------------------------|---------------------------------|
| cm | <input type="checkbox"/> size 1 | <input type="checkbox"/> size 2 | <input type="checkbox"/> size 3 |
| H | 6 | 8 | 10 |
| L | 10,5 | 12,5 | 14,5 |

Thoracic Supports for Inserto Back Effecto Lato *Please, indicate the type, the shape of the brackets, the pad and the size desired

| | | |
|---|--|---|
| Type of Bracket | Shape of the Pad | |
| Fixed <input type="checkbox"/> RH <input type="checkbox"/> LH | Flat <input type="checkbox"/> RH <input type="checkbox"/> LH |  |
| Swing-Away <input type="checkbox"/> RH <input type="checkbox"/> LH | Contoured <input type="checkbox"/> RH <input type="checkbox"/> LH |  |
| Detachable <input type="checkbox"/> dx <input type="checkbox"/> sx | Bracket shape (for the selection see TECHNICAL INFORMATION) | |
| | type A: <input type="checkbox"/> RH <input type="checkbox"/> LH | type B: <input type="checkbox"/> RH <input type="checkbox"/> LH |

| | | | | |
|----|---------------------------------|---------------------------------|---------------------------------|---------------------------------|
| cm | <input type="checkbox"/> size 1 | <input type="checkbox"/> size 2 | <input type="checkbox"/> size 3 | <input type="checkbox"/> size 4 |
| H | 6 | 8 | 10 | 12 |
| L | 8 | 10 | 12 | 15 |

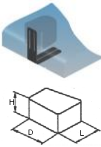
| | | | |
|----|---------------------------------|---------------------------------|---------------------------------|
| cm | <input type="checkbox"/> size 1 | <input type="checkbox"/> size 2 | <input type="checkbox"/> size 3 |
| H | 6 | 8 | 10 |
| L | 12 | 14 | 16 |

| | | | | | | | | | | | | | | |
|---|---|---|----|----------------------------|----------------------------|---|-----|---|---|---|----|---|-----|---|
| Pedal for barriers <input type="checkbox"/> RH <input type="checkbox"/> LH | Abductor wedge only with rigid seat base | | | | | | | | | | | | | |
| <input type="checkbox"/> Vehicle Transportation Kit* <small>(Only frame height 43cm and with 300mm and 500mm posterior wheels) *according to the ISO 7176-19 standard: do not use the wheelchair as a seat in the vehicle if the weight of the user is lower than 22 kg</small> |  | <table border="1"> <tr> <td>cm</td> <td><input type="checkbox"/> S</td> <td><input type="checkbox"/> M</td> </tr> <tr> <td>H</td> <td>7.5</td> <td>9</td> </tr> <tr> <td>D</td> <td>9</td> <td>10</td> </tr> <tr> <td>L</td> <td>7.5</td> <td>9</td> </tr> </table> | cm | <input type="checkbox"/> S | <input type="checkbox"/> M | H | 7.5 | 9 | D | 9 | 10 | L | 7.5 | 9 |
| cm | <input type="checkbox"/> S | <input type="checkbox"/> M | | | | | | | | | | | | |
| H | 7.5 | 9 | | | | | | | | | | | | |
| D | 9 | 10 | | | | | | | | | | | | |
| L | 7.5 | 9 | | | | | | | | | | | | |
| Lower limb accessories | <input type="checkbox"/> removable with lever  <input type="checkbox"/> removable with mounting block  | | | | | | | | | | | | | |
| <input type="checkbox"/> Separate Calf Supports swing-away | Note: if not indicate the abductor wedge will be removable with lever | | | | | | | | | | | | | |
| <input type="checkbox"/> Padded Calf Strap | Please indicate the position of holes under the seat (if not indicated the abductor wedge will be fixed in the standard position) | | | | | | | | | | | | | |
| Cover for legrest tube <input type="checkbox"/> RH <input type="checkbox"/> LH | <input type="checkbox"/> standard | | | | | | | | | | | | | |
| Cover for Knee Angle joint <input type="checkbox"/> RH <input type="checkbox"/> LH | not centred <input type="checkbox"/> on the RH <input type="checkbox"/> on the LH | | | | | | | | | | | | | |
| <input type="checkbox"/> Padding and cover of footplate in leatherette | | | | | | | | | | | | | | |
| Capitis Headrest Comfort size: | Tray | | | | | | | | | | | | | |
| <input type="checkbox"/> Small <input checked="" type="checkbox"/> Medium <input type="checkbox"/> Large | <input type="checkbox"/> Rectangular Wooden Tray w/lateral flip hardware | | | | | | | | | | | | | |
| Fixatis Pelvic belt 2P.2A. with squeeze plastic buckle size: | <input type="checkbox"/> Rectangular Wooden Tray w/detachable hardware | | | | | | | | | | | | | |
| <input type="checkbox"/> XS <input checked="" type="checkbox"/> S <input type="checkbox"/> M | <input type="checkbox"/> Padding for Tray | | | | | | | | | | | | | |
| Fixatis Dynamic Butterfly Harness | | | | | | | | | | | | | | |
| <input type="checkbox"/> XS <input type="checkbox"/> S <input type="checkbox"/> M | | | | | | | | | | | | | | |

- Kit of ABS laterals multi-adjustable, detachable and w/multi-adjustable arm support**
in width and depth with 2.5 cm gap

make a selection:

- o small arm support (from US to XS0)
(dimensions: 5 cm x 25 cm)
- o large arm support (from XS1 to XL)
(dimensions: 6 cm x 30 cm)

make a selection:

- o short vertical bar (from 22 cm to 31 cm*)
- o long vertical bar (from 29 cm to 38 cm*)
- * distance from armrest to the seat rail

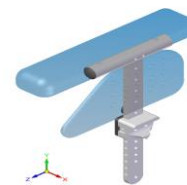

- Multi-adjustable and detachable hips and arms positioning kit**

- pelvis (width, depth, height, adduction/abduction adjustable)
- arm support (width, depth, height, inclination, intra/extra-rotation adjustable)

For independent adjustments referring to the width the gap is 3 cm

The armrests and the hip guides are assembled on the frames as the following indications without possibilities to be modified

- o **small** (from frame size US up to XXS) (armrests dimensions: 8 cm x 22 cm) (hips guide dimensions: 25 cm x 10 cm with slot of 5 cm)
- o **large** (from frame size XS to XS0) (armrests dimensions: 10 cm x 30 cm) (hips guide dimensions: 30 cm x 12 cm with slot of 7.5 cm)



Sizes of the arm supports and hip guides. Note: The components cannot be interchangeable

| Linear Hip Guides | | | | | | ABS Lateral | | | | | |
|-------------------|----|----|-----|----|-----|--------------------------------|----|----|-----|----|-----|
| | cm | US | XXS | XS | XS0 | | cm | US | XXS | XS | XS0 |
| | H | 10 | 10 | 10 | 10 | | H | 11 | 11 | 11 | 13 |
| | L | 25 | 25 | 30 | 30 | | L | 24 | 24 | 24 | 28 |
| Flat Arm Support | | | | | | Armrest of the ABS Lateral kit | | | | | |
| | cm | US | XXS | XS | XS0 | | cm | US | XXS | XS | XS0 |
| | H | 10 | 10 | 10 | 10 | | H | 5 | 5 | 5 | 5 |
| | L | 25 | 25 | 30 | 30 | | L | 27 | 27 | 27 | 33 |

Technical Information

| Titti Size | Maximum Load (kg) | Frame Weight (kg) | Pivot Width (cm) | Maximum overall dimensions in width/length (90° knee angle and footrest positioned forwards) Values expressed in cm | | | | | | | |
|------------|-------------------|-------------------|------------------|--|---------------------------|-----------------------|---------------------------|-----------------------|---------------------------|--------------|--------|
| | | | | standard 300mm wheels | 300mm wheels w/drum brake | standard 400mm wheels | 400mm wheels w/drum brake | standard 500mm wheels | 500mm wheels w/drum brake | 600mm wheels | |
| | | | | US | Rigid | 50 | 14.1 | 69 | 48/96 | 49/96 | 50/99 |
| | Folding | 50 | 14.9 | 53/96 | 54/96 | 55/99 | 58/99 | | 55/101 | 58/101 | 55/104 |
| XXS | Rigid | 50 | 14.4 | 69 | 53/96 | 54/96 | 55/99 | 58/99 | 55/101 | 58/101 | 55/104 |
| | Folding | 50 | 15.3 | | 53/99 | 54/99 | 55/100 | 58/100 | 55/102 | 58/102 | 55/107 |
| XS | Rigid | 50 | 14.7 | 72 | 53/99 | 54/99 | 55/100 | 58/100 | 55/102 | 58/102 | 55/107 |
| | Folding | 50 | 15.6 | | 56/99 | 57/99 | 58/100 | 61/100 | 58/102 | 61/102 | 58/107 |
| XS0 | Rigid | 50 | 15.4 | 75 | 56/99 | 57/99 | 58/100 | 61/100 | 58/102 | 61/102 | 58/107 |
| | Folding | 50 | 15.9 | | | | | | | | |

Note: Frame weight only with wheels, knee angle and footrest as standard configuration. The length dimensions, referred to the average values, are subjected to variations due to the displacement of the wheel plates. The values reported are intended for the standard configuration.

| Titti Size | User Parameters | | Frame Depth Adjustments (cm) | Cushion Size (IW x D) (cm) | Supporto Back sizes (cm) | | | | Effetto Lato Back sizes (cm) | | | |
|------------|-------------------|-----------------|------------------------------|----------------------------|--------------------------|--------|-------------|-------------|------------------------------|--------|-------------|--|
| | Pelvis Width (cm) | Seat Depth (cm) | | | Backrest | Height | Shell Width | Trunk Width | Backrest | Height | Shell Width | Trunk Width |
| US | 20-30 | 28-38 | da 36 a 44 | 30x38 | 3033 | 33 | 27 | 17-23 | 3033 | 33 | 30 | w/bracket A 18-28 w/bracket B 13-23 |
| XXS | 26-36 | 28-38 | da 36 a 44 | 36x38 | 3336 | 36 | 30 | 20-26 | 3338 | 38 | 33 | w/bracket A 21-31 w/bracket B 16-26 |
| XS | 26-36 | 32-42 | da 40 a 48 | 36x42 | 3640 | 40 | 33 | 23-29 | 3642 | 42 | 36 | w/bracket A 24-34 w/bracket B 19-29 |
| XS0 | 29-39 | 34-44 | da 40 a 48 | 39x45 | 3944 | 44 | 36 | 26-34 | 3945 | 45 | 39 | w/bracket A 27-37 w/bracket B 22-32 |